



BURY Cradle universal

EN Installation manual

BURY Cradle universal

Index

Introductory information	4
1. General	4
2. Security guidelines	4
Installation of the system	6
3. Scope of supply	6
4. Installation of the system	7
5. Installing the BURY Cradle universal in the vehicle	9
6. Positioning and removing the mobile phone	11
7. Turning the cradle	13
Further information	14
8. Service	14

1. General

Dear customer,

Congratulations on purchasing a BURY telephone holder for cellular phones. You have chosen a high quality product that is extremely easy to use. Please read the installation manual carefully so that you can fully enjoy your BURY product.

If you have any further questions concerning installation or operation of this device, please contact your dealer. He will be happy to give you reliable advice. You can also contact our hotline. Our phone and fax numbers are listed in the chapter Service.

Have a good trip!

2. Security guidelines

Position

Install the cradle in the vehicle so that your field of vision is not impaired and the components are not mounted in the impact zone of the passenger compartment or in the airbag inflation zones. Very important: please observe the car manufacturer's information (operating manual) as regards "accessories". If in doubt, please contact a specialist workshop to get information on the correct position for installation in the vehicle.



Intended use

We shall not be liable for damages or malfunctions due to improper use of the hands-free system. Therefore, do not expose the device to moisture, extreme temperatures or shocks and follow the procedure described in the installation manual carefully.



Use while driving

Operate the smartphone in the holder only when the situation allows it and when you do not endanger, harm, constrain, or annoy other road users. The volume of the smartphone has to be set in a way that exterior noise is still audible.

Important:

- ▶ The driver is ultimately responsible for the safe operation and control of their vehicle at all times.
- ▶ Research indicates that there is a risk to safety when the driver of a motor vehicle is distracted and using a mobile phone while driving can be a distraction.
- ▶ The manufacturer strongly recommends that you use a hands-free solution for a phone call when driving.

Faults

Do not use the telephone holder if you detect or assume a defect. In this case, contact a Bury specialised dealer or our hotline. Improper repairs can be dangerous for you. Therefore, only skilled personnel may perform inspections.

3. Scope of supply

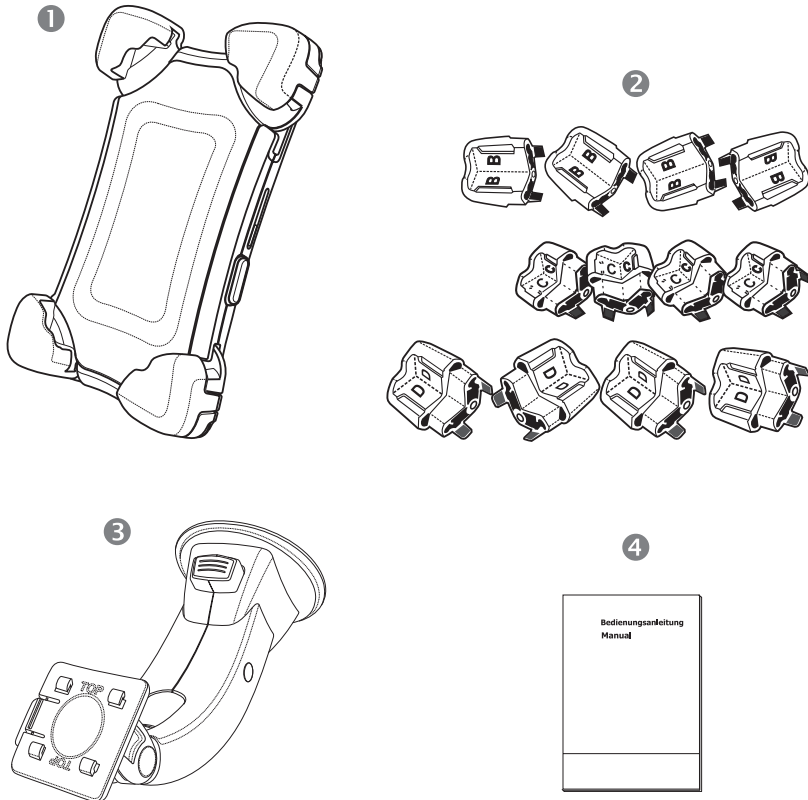

The BURY Cradle universal is supplied with different combinations of components, depending on the sales regions (countries). The operating manual refers to all versions.

Description of the components:

- 1) Cradle
- 2) Set of tips for specific mobile phone models
- 3) Window Mount
- 4) Installation manual

Note:

► If certain components are added or omitted you will receive the corresponding information on a separate enclosure.

4. Installation of the system

Important:

► When positioning the cradle please take care that the device does not impair the view onto the road, that it will not be installed in the impact zone of the passenger compartment (amongst others in the airbag inflation zones) and that the cable may be laid without any problems.

Step 1:

Adjusting corner fasteners to wide ranging models of mobile phone

To be able to select the suitable type of corner fastener for a certain model of mobile phone / smartphone, please familiarize yourself with the corresponding compatibility list. This list is available on our internet site in the download area for the product at www.bury.com.

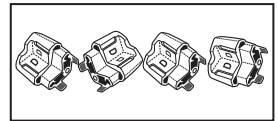

Important:

► Every corner fastener set is equipped with a letter notation which is positioned on the interior side of the corner fastener.

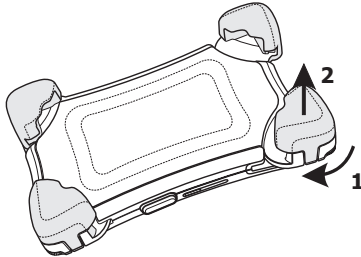
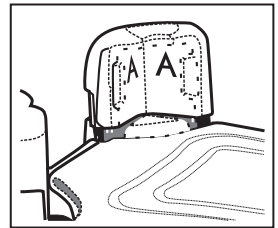

1. Turn the corner fastener with the rotary knob (1) in a clockwise direction.
2. Detach the corner fastener in the direction of the arrow (2).
3. Fit the correct ending for the corner fastener and tighten it by turning it anticlockwise.
4. Repeat the above steps with the remaining three corner fasteners.

Step 2:**Adapting the BURY Cradle universal to the size of the mobile phone**

To be able to adapt the cradle to the size of the mobile phone lift all of the adjustment locks by pressing the release buttons **1, 2, 3**.

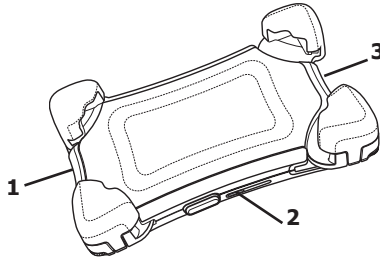

Firstly, adjust the lower width of the cradle to the width of the mobile phone and press button **1** in order to block the set position. Next adjust the height and the upper width of the cradle to the height and width of the phone and press in keys **2** and **3** in order to block the set positions.

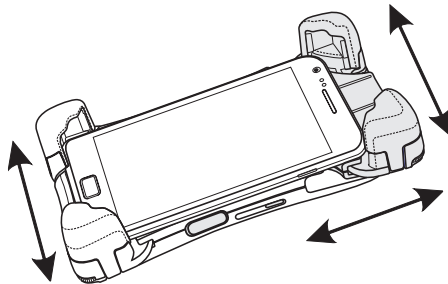
**Please note:**

► It is possible to set all positions of the cradle at the same time by lightly pressing button **1, 2** or **3**.

Step 3: Adjusting the corner fastener

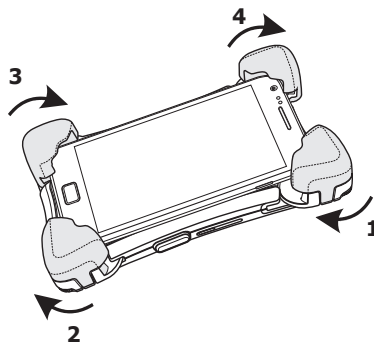

Adjust the corner fastener to the thickness of the phone – remove it by turning it in a clockwise direction, tighten it by turning it anticlockwise.

5. Installing the BURY Cradle universal in the vehicle

Mount the Window Mount and insert mobile phone holder

Put the Window Mount on a smooth, dry, dust-free and oil free surface. The Window Mount remains attached to almost all smooth surfaces. The suction pad attachment is especially suitable for rapid and straightforward attachment to the front windscreen. Please use a cleaning cloth to remove grease from the windscreen.

With the help of a suction pad you can attach the telephone holder to the windscreen. To do this, use the press-stud on the Window Mount in order to either increase or decrease the pressure on the suction pad. To do this, use the press-stud on the Window Mount in order to either increase or decrease the pressure on the suction pad. If you press down on the press stud from top to bottom then the suction pad attachment loosens again.

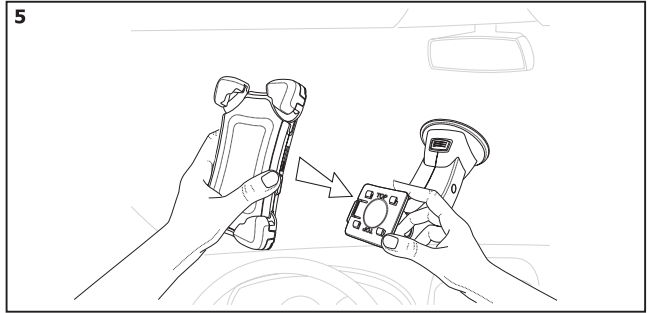
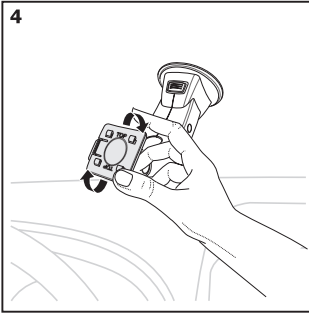
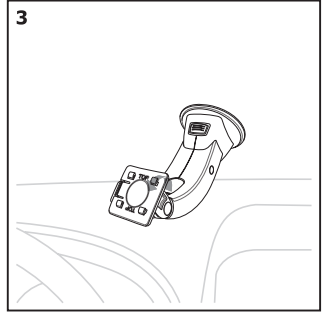
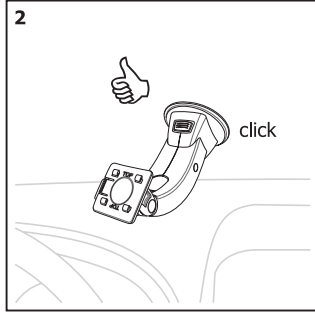
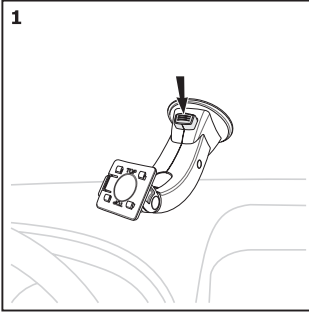

6. Positioning and removing the mobile phone

Positioning the smartphone in the BURY Cradle universal.

Before you position the smartphone in the cradle, remove the blocking mechanism by pressing the locking button in. The locking button is situated on the right hand side of the cradle.

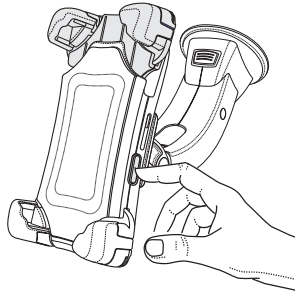

Remove the protective cover from your smartphone. Place the smartphone in the cradle from above.



Press the top part of the cradle downwards and you will hear the smartphone click into the cradle. The correct positioning of the smartphone in the cradle is signalled by a perceptible 'clicking' sound.

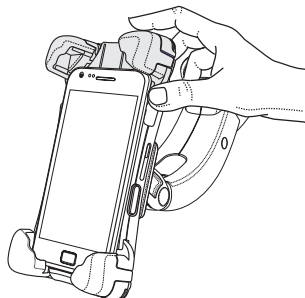

Removing the smartphone from the BURY Cradle universal.

To release the locking mechanism click the button on the right hand side of the cradle.

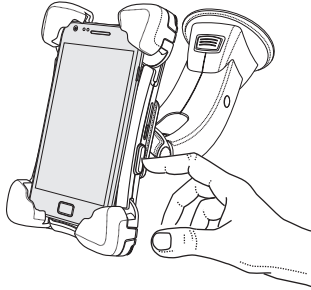

Now withdraw the smartphone by lifting it out of the cradle.



7. Turning the cradle

You can turn the smartphone by 180 degrees (90 degrees to the left or right accordingly) together with the cradle. Move your device so that you can use it for the different functions that you want. The horizontal format, for instance, is suitable for displaying websites in safari-view and for entering text. If you turn the device to the horizontal format, websites are automatically sized to fit the bigger screen width - with text and images shown in bigger format. In the horizontal format there is also additional space for the onscreen keyboard so that you can enter text data more quickly and with fewer errors.

Please note:

► The automatic turning of the display of the smartphone that is being used may have to be activated in advance.

Navigation applications especially benefit from the horizontal format view because all the operational elements of the software are positioned clearly. Due to the reduced horizon in the horizontal format, the 3D map presentation also contains significantly more detailed information.

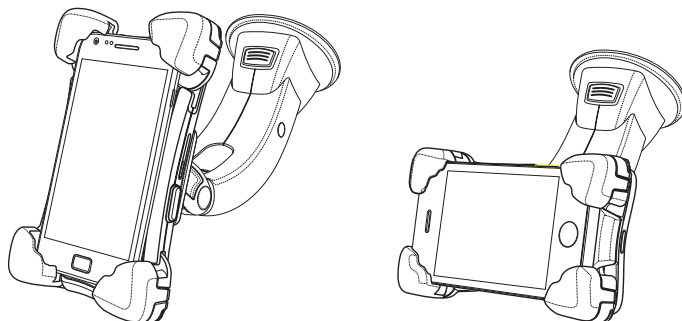

8. Service

In case of general or technical queries, suggestions and comments, please do not hesitate to contact our team at any time. Suggestions and feedback are always welcomed:

Administration:
BURY GmbH & Co. KG
Robert-Koch-Straße 1-7
D-32584 Löhne
Germany

Producer:
BURY Spółka z o.o.
ul. Wojska Polskiego 4
39-300 Mielec
Poland

Hotline: +49(0)180 5 - 842 468*

Faxline: +49(0)180 5 - 842 329*

* 0.14 €/min. Deutsche Telekom AG landline,

the costs of international telephone calls which are made from abroad can vary.

E-Mail: hotline@bury.com

Warranty / Service desk:

The duration of the warranty for the components of this product totals two years subsequent to the date of sale to the end customer. Any warranty claims you may have as an end customer are to be asserted towards your contractual partner. If the corresponding contractual partner is not able to rectify a corresponding fault, please exercise your rights of purchase. If subsequent to agreement with your contractual partner the product is to be sent directly to the manufacturer, then please send it, along with a detailed description of the fault in the German or English language and a copy of the proof of purchase, directly to our service team:

BURY GmbH & Co. KG
Im Hause DPD Depot 103
Robinienweg
D-03222 Lübbenau
Germany

Specific explanations regarding the assertion of claims based on defects of the product (warranty / guarantee / service) for certain countries can be found at the end of these instructions.

Information on the disposal of electrical goods in the EU

The crossed out wheellie bin symbol means that electrical and electronic products, batteries and accumulators must be disposed of separately in the European Union. Please do not dispose of any such products in your normal household waste. As the owner of a product of this sort you are legally obliged to dispose of it at your local dumping site or recycling centre, where you are able to leave your waste electrical goods free of charge.

EXPRESS WARRANTY AGAINST DEFECTS – AUSTRALIA **EFFECTIVE 1st JANUARY, 2012**

This product if imported by Point to Point Technology Pty Ltd is warranted in Australia to be free from any defect in material and workmanship, subject to the following terms and conditions.

Who provides this warranty: POINT TO POINT TECHNOLOGY PTY LTD
2/2 KEYSBOROUGH CLOSE, KEYSBOROUGH VIC 3173
TOLL FREE: 1300 550 720
EMAIL: service@ptp.net.au

Geographical Region: PRODUCTS PURCHASED IN AUSTRALIA imported by
Point to Point Technology Pty Ltd

Warranty Period: 2 YEARS FROM DATE OF PURCHASE (please retain your receipt as your
proof of purchase will be required to valid warranty claim)

WARRANTY CLAIM PROCESS

In the unfortunate event of a failure of your product, please contact Point to Point Technology Pty Ltd (PTP) on our Toll Free number: 1300 550 720.

PTP will ask you to provide evidence of your purchase receipt to establish the warranty claim is within the 2 year warranty period. Failure to provide your purchase receipt will result in PTP rejecting your warranty claim.

PTP offers an advance replacement of your faulty product. Please note our advance replacement units are a like-for-like product and may be refurbished units that are of the exact same model and version. Goods presented for repair may be replaced by refurbished goods of the same type rather than being repaired. Refurbished parts may be used to repair the goods.

Upon validation of your warranty claim, PTP will send your replacement unit freight-paid and include a pre-paid return bag for the return of the faulty product. If you choose do not wish to proceed with the warranty claim, you must return the replacement unit to us using the pre-paid return bag. Failure by the customer to return either unit within 14 days may incur a charge for the cost of the replacement unit.

WARRANTY EXCLUSIONS

Failure to provide a proof of purchase will result in your warranty claim being rejected.

Product failure due to customer misuse, abuse or abnormal use.

Failure by the customer to take reasonable care.

Failure due to not using the product in accordance with instructions stated in the manufactures user guide.

Product failure due to recommended installation procedures not being followed as stated in the manufacturer's user guide.

YOUR RIGHTS UNDER THE AUSTRALIAN CONSUMER LAW

Our goods come with guarantees that cannot be excluded under the Australian Consumer Law.

You are entitled to a replacement or refund for a major failure and for compensation for any other reasonably foreseeable loss or damage. You are entitled to have goods repaired or replaced if the goods fail to be of acceptable quality and the failure does not amount to a major failur

Version: 11/2011
Errors and omissions excepted.
25.1434.0-01-161111

© 2011 by BURY. All rights reserved.